

Background

5.1 An application for a new Premises Licence, by Onur Bozoglu in respect of Wood Green Mini Market, 108 Alexandra Road London N8

5.2 **Details of the application being sought under the Premises Licence– APP 1**

The Provision of Sale of alcohol

Supply of Alcohol

Monday- Sunday 0700 to 2300

For consumption **OFF** the premises

Hours open to the public

Monday to Sunday 0700 to 2300

General-all four licensing objectives

5.3 **Crime and Disorder**

See Part P of the application form

5.4 **Public Safety**

5.5 **Public Nuisance**

5.6 **Child Protection**

6. RELEVANT REPRESENTATIONS (CONSULTATION)

Responsible authorities:

6.1 **Comments of Metropolitan Police**

No representation made

6.2 **Comments of Regulatory Services:**

Environmental Health – Enforcement Response

Have made representation, and the applicant has agreed the condition. The representation is therefore now withdrawn. **Appendix 2**

Trading Standards

Have made representation to this application, which are agreed and are therefore withdrawn **App 3**

6.3 London Fire and Civil Defence Authority

No representation

6.4 Planning Services

Have made no representation to this application

6.5 Comments of Child Protection Agency or Nominee

No representation made on this matter

7.0 Interested Parties

Representations has been received against this application and a petition (**App 4**) there is also a letter in support of the application. **App 5**

The applicant has also written a letter to the residents in response to the concerns they have raised. **App 6**

8.0 Financial Comments

The fee which would be applicable for this application was **£190.00**.

App 1 – APPLICATION FORM



AG1047219
WK/246015

**Application for a premises licence to be granted
under the Licensing Act 2003**

PLEASE READ THE FOLLOWING INSTRUCTIONS FIRST

Before completing this form please read the guidance notes at the end of the form.
If you are completing this form by hand please write legibly in block capitals. In all cases ensure that your answers are inside the boxes and written in black ink. Use additional sheets if necessary.
You may wish to keep a copy of the completed form for your records.

I/We Mr Onur Bozoglu
(Insert name(s) of applicant)

apply for a premises licence under section 17 of the Licensing Act 2003 for the premises described in Part 1 below (the premises) and I/we are making this application to you as the relevant licensing authority in accordance with section 12 of the Licensing Act 2003

Part 1 – Premises Details

Postal address of premises or, if none, ordnance survey map reference or description Wood Green Mini Market, 108 Alexander Road			
Post town	London	Post code	N8 0LJ

Telephone number at premises (if any)	
Non-domestic rateable value of premises	£8400

Part 2 - Applicant Details

Please state whether you are applying for a premises licence as
Please tick yes

- a) an individual or individuals * please complete section (A)
- b) a person other than an individual *
 - i. as a limited company please complete section (B)
 - ii. as a partnership please complete section (B)
 - iii. as an unincorporated association or please complete section (B)
 - iv. other (for example a statutory corporation) please complete section (B)
- c) a recognised club please complete section (B)
- d) a charity please complete section (B)

- e) the proprietor of an educational establishment please complete section (B)
- f) a health service body please complete section (B)
- g) a person who is registered under Part 2 of the Care Standards Act 2000 (c14) in respect of an independent hospital please complete section (B)
- h) the chief officer of police of a police force in England and Wales please complete section (B)

* If you are applying as a person described in (a) or (b) please confirm:

Please tick yes

- I am carrying on or proposing to carry on a business which involves the use of the premises for licensable activities; or
- I am making the application pursuant to a
 - statutory function or
 - a function discharged by virtue of Her Majesty's prerogative

(A) INDIVIDUAL APPLICANTS (fill in as applicable)

Mr <input checked="" type="checkbox"/>	Mrs <input type="checkbox"/>	Miss <input type="checkbox"/>	Ms <input type="checkbox"/>	Other Title (for example, Rev)	
Surname Bozoglu			First names Onur		
I am 18 years old or over				<input checked="" type="checkbox"/> Please tick yes	
Current postal address if different from premises address		16 Wiltshire Gardens			
Post Town	London			Postcode	N4 1HG
Daytime contact telephone number					
E-mail address (optional)					

SECOND INDIVIDUAL APPLICANT (if applicable)

Mr <input type="checkbox"/>	Mrs <input type="checkbox"/>	Miss <input type="checkbox"/>	Ms <input type="checkbox"/>	Other Title (for example, Rev)	
Surname			First names		
I am 18 years old or over				<input type="checkbox"/> Please tick yes	

Current postal address if different from premises address			
Post Town		Postcode	
Daytime contact telephone number			
E-mail address (optional)			

(B) OTHER APPLICANTS

Please provide name and registered address of applicant in full. Where appropriate please give any registered number. In the case of a partnership or other joint venture (other than a body corporate), please give the name and address of each party concerned.

Name
Address
Registered number (where applicable)
Description of applicant (for example, partnership, company, unincorporated association etc.)
Telephone number (if any)
E-mail address (optional)

Part 3 Operating Schedule

When do you want the premises licence to start?

Day		Month		Year	
1	5	0	4	2	0
				1	3

If you wish the licence to be valid only for a limited period, when do you want it to end?

Day		Month		Year	

Please give a general description of the premises (please read guidance note1)
Supermarket Please refer to the enclosed plan.

If 5,000 or more people are expected to attend the premises at any one time, please state the number expected to attend.

What licensable activities do you intend to carry on from the premises?

(Please see sections 1 and 14 of the Licensing Act 2003 and Schedules 1 and 2 to the Licensing Act 2003)

Provision of regulated entertainment

Please tick yes

- a) plays (if ticking yes, fill in box A)
- b) films (if ticking yes, fill in box B)
- c) indoor sporting events (if ticking yes, fill in box C)
- d) boxing or wrestling entertainment (if ticking yes, fill in box D)
- e) live music (if ticking yes, fill in box E)
- f) recorded music (if ticking yes, fill in box F)
- g) performances of dance (if ticking yes, fill in box G)
- h) anything of a similar description to that falling within (e), (f) or (g) (if ticking yes, fill in box H)

Provision of entertainment facilities:

- i) making music (if ticking yes, fill in box I)
- j) dancing (if ticking yes, fill in box J)
- k) entertainment of a similar description to that falling within (i) or (j) (if ticking yes, fill in box K)

Provision of late night refreshment (if ticking yes, fill in box L)

Supply of alcohol (if ticking yes, fill in box M)

In all cases complete boxes N, O and P

A

Plays Standard days and timings (please read guidance note 6)			<u>Will the performance of a play take place indoors or outdoors or both – please tick</u> (please read guidance note 2)	Indoors	<input type="checkbox"/>
				Outdoors	<input type="checkbox"/>
				Both	<input type="checkbox"/>
Day	Start	Finish			
Mon			<u>Please give further details here</u> (please read guidance note 3)		
Tue					
Wed			<u>State any seasonal variations for performing plays</u> (please read guidance note 4)		
Thur					
Fri			<u>Non standard timings. Where you intend to use the premises for the performance of plays at different times to those listed in the column on the left, please list</u> (please read guidance note 5)		
Sat					
Sun					

B

Films Standard days and timings (please read guidance note 6)			<u>Will the exhibition of films take place indoors or outdoors or both – please tick</u> (please read guidance note 2)	Indoors	<input type="checkbox"/>
				Outdoors	<input type="checkbox"/>
				Both	<input type="checkbox"/>
Day	Start	Finish	<u>Please give further details here</u> (please read guidance note 3)		
Mon					
Tue					
			<u>State any seasonal variations for the exhibition of films</u> (please read guidance note 4)		
Wed					
Thur					
			<u>Non standard timings. Where you intend to use the premises for the exhibition of films at different times to those listed in the column on the left, please list</u> (please read guidance note 5)		
Fri					
Sat					
Sun					

C

Indoor sporting events Standard days and timings (please read guidance note 6)			<u>Please give further details</u> (please read guidance note 3)
Day	Start	Finish	
Mon			
Tue			<u>State any seasonal variations for indoor sporting events</u> (please read guidance note 4)
Wed			
Thur			<u>Non standard timings. Where you intend to use the premises for indoor sporting events at different times to those listed in the column on the left, please list</u> (please read guidance note 5)
Fri			
Sat			
Sun			

D

Boxing or wrestling entertainments Standard days and timings (please read guidance note 6)			<u>Will the boxing or wrestling entertainment take place indoors or outdoors or both – please tick</u> (please read guidance note 2)	Indoors	<input type="checkbox"/>
				Outdoors	<input type="checkbox"/>
				Both	<input type="checkbox"/>
Day	Start	Finish			
Mon			<u>Please give further details here</u> (please read guidance note 3)		
Tue					
Wed			<u>State any seasonal variations for boxing or wrestling entertainment</u> (please read guidance note 4)		
Thur					
Fri			<u>Non standard timings. Where you intend to use the premises for boxing or wrestling entertainment at different times to those listed in the column on the left, please list</u> (please read guidance note 5)		
Sat					
Sun					

E

Live music Standard days and timings (please read guidance note 6)			Will the performance of live music take place indoors or outdoors or both – please tick (please read guidance note 2)	Indoors	<input type="checkbox"/>
				Outdoors	<input type="checkbox"/>
				Both	<input type="checkbox"/>
Day	Start	Finish			
Mon			Please give further details here (please read guidance note 3)		
Tue					
Wed			State any seasonal variations for the performance of live music (please read guidance note 4)		
Thur					
Fri			Non standard timings. Where you intend to use the premises for the performance of live music at different times to those listed in the column on the left, please list (please read guidance note 5)		
Sat					
Sun					

F

Recorded music Standard days and timings (please read guidance note 6)			Will the playing of recorded music take place indoors or outdoors or both – please tick (please read guidance note 2)	Indoors	<input type="checkbox"/>
				Outdoors	<input type="checkbox"/>
				Both	<input type="checkbox"/>
Day	Start	Finish			
Mon			Please give further details here (please read guidance note 3)		
Tue			State any seasonal variations for the playing of recorded music (please read guidance note 4)		
Wed			Non standard timings. Where you intend to use the premises for the playing of recorded music at different times to those listed in the column on the left, please list (please read guidance note 5)		
Thur					
Fri					
Sat					
Sun					

G

Performances of dance Standard days and timings (please read guidance note 6)			Will the performance of dance take place indoors or outdoors or both – please tick (please read guidance note 2)	Indoors	<input type="checkbox"/>
				Outdoors	<input type="checkbox"/>
				Both	<input type="checkbox"/>
Day	Start	Finish	Please give further details here (please read guidance note 3)		
Mon					
Tue					
			State any seasonal variations for the performance of dance (please read guidance note 4)		
Wed					
Thur					
			Non standard timings. Where you intend to use the premises for the performance of dance at different times to those listed in the column on the left, please list (please read guidance note 5)		
Fri					
Sat					
Sun					

H

Anything of a similar description to that falling within (e), (f) or (g) Standard days and timings (please read guidance note 6)			<u>Please give a description of the type of entertainment you will be providing</u>		
Day	Start	Finish	<u>Will this entertainment take place indoors or outdoors or both – please tick</u> (please read guidance note 2)	Indoors	<input type="checkbox"/>
Mon				Outdoors	<input type="checkbox"/>
				Both	<input type="checkbox"/>
Tue			<u>Please give further details here</u> (please read guidance note 3)		
Wed					
Thur			<u>State any seasonal variations for entertainment of a similar description to that falling within (e), (f) or (g)</u> (please read guidance note 4)		
Fri					
Sat			<u>Non standard timings. Where you intend to use the premises for the entertainment of a similar description to that falling within (e), (f) or (g) at different times to those listed in the column on the left, please list</u> (please read guidance note 5)		
Sun					

1

Provision of facilities for making music Standard days and timings (please read guidance note 6)			<u>Please give a description of the facilities for making music you will be providing</u>	
			<u>Will the facilities for making music be indoors or outdoors or both – please tick</u> (please read guidance note 2)	
			Outdoors <input type="checkbox"/>	
			Both <input type="checkbox"/>	
Day	Start	Finish	<u>Please give further details here</u> (please read guidance note 3)	
Mon				
Tue				
Wed				
Thur				
			<u>State any seasonal variations for the provision of facilities for making music</u> (please read guidance note 4)	
			<u>Non standard timings. Where you intend to use the premises for provision of facilities for making music at different times to those listed in the column on the left, please list</u> (please read guidance note 5)	

J

Provision of facilities for dancing Standard days and timings (please read guidance note 6)			<u>Will the facilities for dancing be indoors or outdoors or both – please tick</u> (see guidance note 2)	Indoors	<input type="checkbox"/>
				Outdoors	<input type="checkbox"/>
				Both	<input type="checkbox"/>
Day	Start	Finish	<u>Please give a description of the facilities for dancing you will be providing</u>		
Mon			<u>Please give further details here</u> (please read guidance note 3)		
Tue					
Wed			<u>State any seasonal variations for providing dancing facilities</u> (please read guidance note 4)		
Thur					
Fri			<u>Non standard timings. Where you intend to use the premises for the provision of facilities for dancing entertainment at different times to those listed in the column on the left, please list</u> (please read guidance note 5)		
Sat					
Sun					

K

Provision of facilities for entertainment of a similar description to that falling within i or j Standard days and timings (please read guidance note 6)			<u>Please give a description of the type of entertainment facility you will be providing</u>		
Day	Start	Finish	<u>Will the entertainment facility be indoors or outdoors or both – please tick</u> (please read guidance note 2)	Indoors	<input type="checkbox"/>
Mon				Outdoors	<input type="checkbox"/>
				Both	<input type="checkbox"/>
Tue			<u>Please give further details here</u> (please read guidance note 3)		
Wed					
Thur			<u>State any seasonal variations for the provision of facilities for entertainment of a similar description to that falling within i or j</u> (please read guidance note 4)		
Fri					
Sat			<u>Non standard timings. Where you intend to use the premises for the provision of facilities for entertainment of a similar description to that falling within i or j at different times to those listed in the column on the left, please list</u> (please read guidance note 5)		
Sun					

L

Late night refreshment Standard days and timings (please read guidance note 6)			Will the provision of late night refreshment take place indoors or outdoors or both – please tick (please read guidance note 2)	Indoors	<input type="checkbox"/>
				Outdoors	<input type="checkbox"/>
				Both	<input type="checkbox"/>
Day	Start	Finish	<u>Please give further details here</u> (please read guidance note 3)		
Mon					
Tue			<u>State any seasonal variations for the provision of late night refreshment</u> (please read guidance note 4)		
Wed					
Thur			<u>Non standard timings. Where you intend to use the premises for the provision of late night refreshment at different times, to those listed in the column on the left, please list</u> (please read guidance note 5)		
Fri					
Sat					
Sun					

M

Supply of alcohol Standard days and timings (please read guidance note 6)			Will the supply of alcohol be for consumption (Please tick box) (please read guidance note 7)	On the premises	<input type="checkbox"/>
				Off the premises	<input checked="" type="checkbox"/>
				Both	<input type="checkbox"/>
Day	Start	Finish	State any seasonal variations for the supply of alcohol (please read guidance note 4)		
Mon	07:00	23:00			
Tue	07:00	23:00			
Wed	07:00	23:00			
Thur	07:00	23:00			
			Non standard timings. Where you intend to use the premises for the supply of alcohol at different times to those listed in the column on the left, please list (please read guidance note 5)		
Fri	07:00	23:00			
Sat	07:00	23:00			
Sun	07:00	23:00			

State the name and details of the individual whom you wish to specify on the licence as premises supervisor

Name Mr Onur Bozoglu	
Address 16 Wiltshire Gardens London	
Postcode	N4 1HG
Personal Licence number (if known) Not Known Yet	
Issuing licensing authority (if known) L.B. of Haringey	

N

Please highlight any adult entertainment or services, activities, other entertainment or matters ancillary to the use of the premises that may give rise to concern in respect of children (please read guidance note 8)
 N/A

O

Hours premises are open to the public Standard days and timings (please read guidance note 6)			State any seasonal variations (please read guidance note 4) N/A
Day	Start	Finish	Non standard timings. Where you intend the premises to be open to the public at different times from those listed in the column on the left, please list (please read guidance note 5) N/A
Mon	07:00	23:00	
Tue	07:00	23:00	
Wed	07:00	23:00	
Thur	07:00	23:00	
Fri	07:00	23:00	
Sat	07:00	23:00	
Sun	07:00	23:00	

P Describe the steps you intend to take to promote the four licensing objectives:

a) General – all four licensing objectives (b,c,d,e) (please read guidance note 9)

Please see below.

b) The prevention of crime and disorder

CCTV shall be installed, operated and maintained in agreement with the Police. The system will enable frontal identification of every person entering the premises. The system shall record in real time and operate whilst the premises are open for licensable activities. The recordings shall be kept available for a minimum of 31 days. Recordings shall be made available to an Authorised Officer or a Police Officer (subject to the Data Protection Act 1998) within 24 hours of any request.

All instances of crime and disorder shall be reported to the police.

An incident book shall be used to record all instances of public disorder.

c) Public safety

All exit routes shall be kept unobstructed, with non-slippery and even surfaces, free of trip hazards and clearly identified.

d) The prevention of public nuisance

Prominent, clear and legible notices must be displayed at all exits requesting the public to respect the needs of local residents and to leave the premises and the area quietly.

e) The protection of children from harm

challenge 25 scheme will be implemented

staff training and refusal logs to be kept at the premise

Please tick yes

- I have made or enclosed payment of the fee
- I have enclosed the plan of the premises
- I have sent copies of this application and the plan to responsible authorities and others where applicable
- I have enclosed the consent form completed by the individual I wish to be premises supervisor, if applicable
- I understand that I must now advertise my application
- I understand that if I do not comply with the above requirements my application will be rejected

IT IS AN OFFENCE, LIABLE ON CONVICTION TO A FINE UP TO LEVEL 5 ON THE STANDARD SCALE, UNDER SECTION 158 OF THE LICENSING ACT 2003 TO MAKE A FALSE STATEMENT IN OR IN CONNECTION WITH THIS APPLICATION

Part 4 – Signatures (please read guidance note 10)

Signature of applicant or applicant's solicitor or other duly authorised agent (See guidance note 11). **If signing on behalf of the applicant please state in what capacity.**

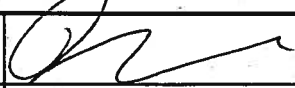
Signature	
Date	14 th March 2013
Capacity	Authorised Agent

For joint applications signature of 2nd applicant or 2nd applicant's solicitor or other authorised agent. (please read guidance note 12). **If signing on behalf of the applicant please state in what capacity.**

Signature	
Date	
Capacity	

Contact name (where not previously given) and postal address for correspondence associated with this application (please read guidance note 13) Licensing Department NARTS 55 Stoke Newington High Street			
Post town	London	Post code	N16 8EL
Telephone number (if any)	020 3603 3218		
If you would prefer us to correspond with you by e-mail your e-mail address (optional) info@narts.org.uk			

Notes for Guidance

1. Describe the premises. For example the type of premises, its general situation and layout and any other information which could be relevant to the licensing objectives. Where your application includes off-supplies of alcohol and you intend to provide a place for consumption of these off-supplies you must include a description of where the place will be and its proximity to the premises.
2. Where taking place in a building or other structure please tick as appropriate. Indoors may include a tent.
3. For example the type of activity to be authorised, if not already stated, and give relevant further details, for example (but not exclusively) whether or not music will be amplified or unamplified.
4. For example (but not exclusively), where the activity will occur on additional days during the summer months.
5. For example (but not exclusively), where you wish the activity to go on longer on a particular day e.g. Christmas Eve.
6. Please give timings in 24 hour clock (e.g. 16:00) and only give details for the days of the week when you intend the premises to be used for the activity.
7. If you wish people to be able to consume alcohol on the premises please tick on, if you wish people to be able to purchase alcohol to consume away from the premises please tick off. If you wish people to be able to do both please tick both.
8. Please give information about anything intended to occur at the premises or ancillary to the use of the premises which may give rise to concern in respect of children, regardless of whether you intend children to have access to the premises, for example (but not exclusively) nudity or semi-nudity, films for restricted age groups, the presence of gaming machines.
9. Please list here steps you will take to promote all four licensing objectives together.
10. The application form must be signed.
11. An applicant's agent (for example solicitor) may sign the form on their behalf provided that they have actual authority to do so.
12. Where there is more than one applicant, both applicants or their respective agents must sign the application form.
13. This is the address which we shall use to correspond with you about this application.

Part A

Consent of individual to being specified as premises supervisor

I MR Onur Bozoglu [full name of prospective premises supervisor]
of 16 Wiltshire Gardens, London N4 1HG [home address of prospective premises supervisor]
hereby confirm that I give my consent to be specified as the designated premises
supervisor in relation to the application for New Licence [type of application]
by MR ONUR BOZOGLU [name of applicant]
relating to a premises licence Not known yet [number of existing licence, if any]
for 108 Alexander Rd London N8 0LJ [name and address of premises to which the application relates]
and any premises licence to be granted or varied in respect of this application made
by MR ONUR BOZOGLU [name of applicant]
concerning the supply of alcohol at 16 Wiltshire Gardens, London N4 1HG
[name and address of premises to which application relates].
I also confirm that I am applying for, intend to apply for or currently hold a personal
licence, details of which I set out below.

Personal licence number Not known yet [insert personal licence number, if any]
Personal licence issuing authority L.A. of Haringey
[insert name and address and telephone number of personal licence issuing authority, if
any]

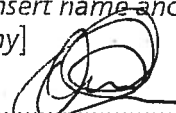
 signed
ONUR BOZOGLU name (please print)
15/03/2013 dated

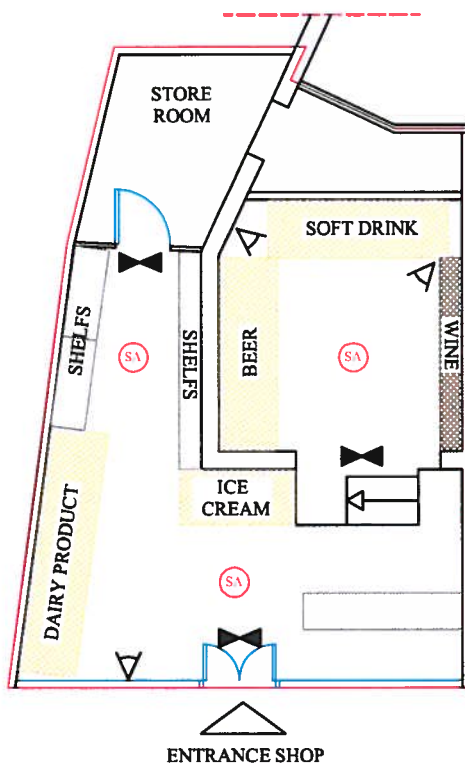

LEGEND	
	FIRE ALARM BELL
	VEGETABLES
	WC AREA
	FRIDGES
	OFF LICENCE SHELVES
	AMBIT OF LICENSED PERMISES
	SAFETY LIGHTS
	SMOKE DETECTOR
	CCTV
	CARBON DIOXIDE FIRE EXTINGUISHER
	9 LT. WATER FIRE EXTINGUISHER
	FIRE BLANKETS

AMENDMENTS	
A	
B	
C	
D	
E	

The contents of this plan including the printed notes are copyright and reproduction in whole or part is not permitted without prior consent of Amalia Torre in writing.

108 ALEXANDRA ROAD N8 0LJ
LONDON

PROPOSED
- GROUND FLOOR PLAN

SCALE 1/100 @A4

Date: 15 MARCH 13

Ref No: ESTER 8

ACT 2003
55 STOKE NEWINGTON HIGH STREET
N16 8EL
TEL: 020 72413636 FAX: 08716615283
www.act2003.com

App 2 – Representation from Enforcement Response - withdrawn

Shah Noshaba

From: Nicolaou George (Enforcement)
Sent: 18 March 2013 12:05
To: Shah Noshaba; Licensing
Cc: Enforcement Response
Subject: WK/000246015

M3PPRef: WK/000246015
M3PPUnique: 000000004319E77AA8F6D211B04E00805FA682C2070091B275CEE796D011AFE900805FA682C200000096322C0000810D9B31C4A36243A85A2CF2809983E9004A3E9B3A7B0000

Licensing Consultation

To: Licensing Officer

From: Enforcement Response Officer (Noise)

Name of Officer preparing representation: **GEORGE NICOLAOU**

cc: Team Leader Enforcement Response, Derek Pearce

Our Reference: WK/000246015

Date: 18th March 2013

Premises: Shop, 108 Alexandra Road, Wood Green, London, N8 0LJ

Type of application: **New**

I would like to confirm that I have considered the above proposal with regard to the prevention of public nuisance on behalf of the Enforcement Response (Noise) Team & would like to make representations to the Application

The operating schedule does not address the prevention of public nuisance from:

- Noise generated from deliveries
- Noise generated from refuse collections
- Noise from plant and machinery
- Light nuisance

This representation recommends that the following alterations/conditions to the operating schedule:

Deliveries and collections.

Deliveries and collections associated with the premises will be arranged between the hours 08:00 and 20:00 so as to minimise the disturbance caused to the neighbours, except for the delivery of newspapers.

Plant and machinery

All plant and machinery is correctly maintained and regularly serviced to ensure that it is operating efficiently and with minimal disturbance to neighbours arising from noise

Dealing with complaints

A complaints book will be held on the premises to record details of any complaints received from neighbours. The information is to include, where disclosed, the complainant's name, location, date time and subsequent remedial action undertaken. This record must be made available at all times for inspection by council officers

Prevention of nuisance from litter

Adequate receptacles for use by patrons will be provided. The positioning of the receptacles will be agreed with the licensing officer

Prevention of nuisance from light

Illuminated external signage shall be switched off when the premises is closed

Security lights will be positioned to minimise light intrusion to nearby residential premises

App 3 – Representation from Trading Standards - withdrawn

Shah Noshaba

From: Tillet Karen
Sent: 27 March 2013 13:04
To: Licensing
Subject: RE: New Premises Licence Application - Wood Green Mini Market, 108 Alexandra Park Road, N8 (WK/246015)

I would like to make a representation on behalf of Trading Standards regarding the above application in relation to the potential sale of alcohol to underage children.

The measures outlined in Section P(e) – Protection of Children are not detailed enough

Measures that we would expect to see in place are detailed below:

- All relevant staff must be trained in the prevention of underage sales including; knowledge of the law and guidance on how to assess age and recognise acceptable ID. Such ID must bear a photograph, date of birth and a holographic mark
- To keep a written record of staff training confirming they have understood the legal requirements

Kind regards,
Karen

Karen Tillet

Joint Trading Standards Manager - Haringey and Waltham Forest

London Borough of Haringey Trading Standards

Lee Valley Technopark,

Ashley Road, Tottenham

London N17 9LN

Telephone: 020 8489 5885

Alt Telephone: 020 8489 8233

Fax: 020 8489 5554

From: Shah Noshaba
Sent: 18 March 2013 11:27
To: Building Control; Enforcement Response; Food Haringey; Pearce Derek; Planning Enforcement; Whitehouse Rebecca; Tillet Karen; Thomas Simon; 'YR_Licensing@met.pnn.police.uk'; 'Fire'; Morris Marion; Ekemezuma Felicia; Tate-Manning Chantel; Maher Vincent
Cc: Barrett Daliah; Anderson Chanel
Subject: New Premises Licence Application - Wood Green Mini Market, 108 Alexandra Park Road, N8 (WK/246015)

Dear RA's,

Please find attached an application for a New Premises Licence for the above named premises, received today.

Please note that the last day for consultation is the 14th April 2013.

App 4– Representation from Other Parties

Shah Noshaba

From: Shah Noshaba on behalf of Licensing
Sent: 08 April 2013 12:39
To: 'info@narts.org.uk'
Subject: FW: Wood Green Mini Market

Dear Sir/ Madam,

Please see below an objection to the aforementioned application by Councillor Stewart.

You will be advised of a committee hearing date after the consultation period has ended.

If you have any questions please do not hesitate to contact me.

Yours sincerely,

Noshaba Shah |
Licensing Officer

Single Front Line | Place and Sustainability
Unit 271 Lee Valley Technopark | Ashley Road | Tottenham Hale | London | N17 9LN

Tel: 020 8489 5536 | Fax: 0208489 5528
Noshaba.shah@haringey.gov.uk |

From: Cllr Stewart James
Sent: 06 April 2013 15:43
To: MemberEnquiries; Licensing
Cc: Cllr Strickland Alan
Subject: Wood Green Mini Market

To whom it may concern,

As a councillor for Noel Park, I would like to object to a supply of alcohol licence being granted for the Wood Green Mini Market.

As you will be aware, anti-social behavior – often involving alcohol – is a major issue in Noel Park. I believe this will be exacerbated if this license is granted for this reason:

The proposed location of the Wood Green Mini Market is extremely close to two alleyways: St Martins Walk and Hazel Mews. These areas are already used for anti-social behaviour and it is highly likely that they will become off-site drinking areas.

Please can someone from the licencing team call me to discuss the procedure for this application?

Many thanks,
James

James Stewart
Labour Councillor for Noel Park Ward

james.stewart@haringey.gov.uk

Licensing Team
Units 271-272
Lee Valley Technopark
Ashley Road
Tottenham
London N17 9LN

Email licensing@haringey.gov.uk

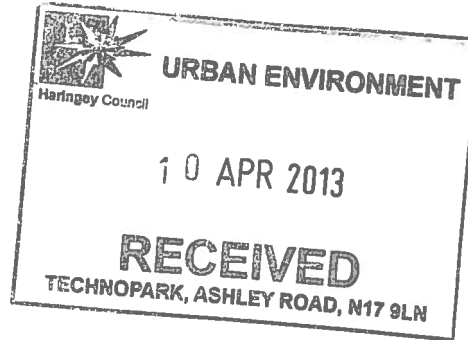

4th April 2013

To whom it may concern,

**Objection to the licensing application of Wood Green Mini-Mart,
(the old Pet Shop) 108 Alexandra Road London N8 0LJ**

I am writing to register an objection to the application for a premises licence by the above proposed convenience store to sell alcohol for consumption off site between 7am until 11pm Sunday to Saturday. The basis for this opposition is that granting a license will not promote the licensing objectives as stated in the Licensing Act 2003, particularly the prevention of public nuisance, crime and disorder and public safety.

If granted, a license would provide a further source of alcohol in an area already so heavily populated with licensed premises, late-opening betting shops and amusement arcades that crime, disorder and public nuisance have already reached problem levels for the local police, despite the use of ASBOs to stop youths congregating outside these premises.

If granted, it is very likely that off-site drinking will occur in the two local alleyways next to the store, which are already dirty and often used as urinals by passers by. In addition, drunken behavior in these alleyways will intimidate local residents some of whom need to walk down one of the alleyways to enter their homes.

The area around the premises is densely populated, with no other nearby shop that sells alcohol so late or so early. It is reasonable to expect that many local consumers of alcohol from this estate and the surrounding streets will converge on this shop. Again, this can create potential problems.

The period for objecting to the licence ends on 14th April. I and other residents would like you to raise an objection on our behalf on the above grounds.

Yours sincerely





Mr Phillip Kowalski,
Mr Jugjit Samra

101 Alexandra Rd,

Worsley,

London
N8 0LJ.

86 Alexandra Road

London N8 0LJ

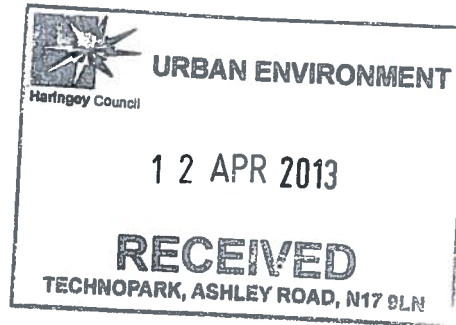

9th April 2013

**Objection to the licensing application of Wood Green Mini-Mart,
108 Alexandra Road London N8 0LJ**

Dear Mr/Madam,

I am writing to register an objection to the application for a premises licence by the above proposed convenience store to sell alcohol for consumption off site between 7am until 11pm Sunday to Saturday. The basis for this opposition is that granting a license will not promote the licensing objectives as stated in the Licensing Act 2003, particularly the prevention of public nuisance, crime and disorder and public safety. Full details of the objections are shown in the document attached, but here is a brief summary:

If granted, a license would provide a further source of alcohol in an area already so heavily populated with licensed premises, late-opening betting shops and amusement arcades that crime, disorder and public nuisance have already reached problem levels for the local police, despite the use of ASBOs to stop youths congregating outside these premises.

If granted, it is very likely that off-site drinking will occur in the two local alleyways next to the store, which are already dirty and often used as urinals by passers by. In addition, drunken behavior in these alleyways will intimidate local residents some of whom need to walk down one of the alleyways to enter their homes.

The area around the premises is densely populated, with no other nearby shop that sells alcohol so late or so early. It is reasonable to expect that many local consumers of alcohol from this estate and the surrounding streets will converge on this shop. Again, this can create potential problems.

The period for objecting to the licence ends on 14th April. I and other residents would appreciate a response to the above concern's/worries and to be informed of any decision when made.

Yours Sincerely

A handwritten signature in black ink, appearing to read 'Donald Dempster', with a long horizontal stroke extending to the right.

Donald Dempster

****I have enclosed a petition, signed by residents which indicates the support of the objection to this application***

FULL DETAILS OF OBJECTION

The proposed application states that the premises are allowed to sell alcohol for consumption off site between 7am until 11pm Sunday to Saturday. Granting a license would provide a further source of alcohol in an area already so heavily populated with licensed premises, late-opening betting shops and amusement arcades that crime, disorder and public nuisance have already reached problem levels for the local police.

For example, at the Turnpike Lane end of Wood Green High Street, the anti-social gatherings of youths outside the four betting shops in this area have led the police to hand ASBOs to a number of youths. However the youths still gather outside each shop, which suggests, despite their best efforts, the police cannot deal with the problem. And neither can the shop companies.

We believe the exact same situation will occur outside the convenience store and it will be just as difficult to police. In fact, given the location of the store off the main road, the situation could be even worse.

Also, there is the very close proximity of the store to two well-known local alleyways, St Martins Walk and Hazel Mews. Hazel mews contains the back entrances to many shops and the front entrances to many flats in it. However, it is not well lit, often has huge waste bins in it and has a curve in it which means that part of it cannot be seen from Alexandra Road beyond a certain point. St Martins Walk has an alcove and a bench in it which is regularly used by smokers. This would suggest that off-site drinking would take place in both these areas. Both alleyways are already filthy and the recessed areas smell like urinals so public drinking would only add further to these problems. Plus, it will disrupt the daily activities of local residents; especially those who walk down Hazel Mews to get into their homes and shops and the mothers who use St Martins Walk as a shortcut to take their young children to the nearby schools and nurseries.

In addition, the premises is situated in a densely populated area, with the huge housing estate of Sky City just across the road. As there are no other nearby stores that sell alcohol so late or so early, it is reasonable to expect that many local consumers from this estate and the surrounding streets will converge on this shop. Again, this can create potential problems.

Residents in this area already suffer noise nuisance and anti-social behavior at all hours of the day and night. It is totally unacceptable to expect them to have to suffer even more disruption from a license which can be prevented.

**I have enclosed a petition, signed by residents which indicates the support of the objection to this application*

Objection to the licensing of Wood Green Mini-Mart, (old Pet Shop) at 108 Alexandra Road London N8 0LJ

We think licensing of this premises to sell alcohol would be a huge mistake. Locally, incidents of nuisance, crime and disorder have already reached problem levels for the local police. This is despite the use of ASBOs to stop drinkers and youths congregating outside *licensed* premises such as Morrison's Wood Green supermarket and drug dealing outside the William Hills and Ladbrokes betting shops at Turnpike Lane.

The prevention of this license would help to stop the levels of public nuisance, crime and disorder from increasing and stop the local public from feeling even less safe in the area.

	Name	Door No.	Post Code	Signature
1	Luce Mackenzie	48	N8 0LA	[Signature]
2	ADE ADEYOYIN	92	N8 0LJ	[Signature]
3	JAMES PAGE	96	N8 0LT	[Signature]
4	ALBAN HETEMI	88	N8 0LT	[Signature]
5	GINTARE PETRASAITIS	86	N8 0LT	[Signature]
6	JIM ANDERSON	88	N8 0LT	[Signature]
7	F. TIBANLICHE	103A	N22	[Signature]
8	Johathan	115	N8 0LG	[Signature]
9	LIPING GUAN	111	N8 0LG	[Signature]
10	Wanda Nkoye	N18		[Signature]
11	A. TSANGARI	109	N8 0LG	[Signature]
12	K. D. L.	103	N8 0LJ	[Signature]
13	P. Kowalski	101	N8 0LJ	[Signature]
14	J. Samra	101	N8 0LJ	[Signature]
15	S. James	100	N8 0LJ	[Signature]
16	WALE ADEYOYIN	92	N8 0LJ	[Signature]
17	JEYLANI SAEED HAJI	84	N8 0LT	[Signature]
18	MOHAMED JEYLAN	84	N8 0LT	[Signature]
19	Abas Abdirahim Abdi	84	N8 0LT	[Signature]
20	Allam Saeed	84	N8 0LJ	[Signature]
21	Abbas Abu	84	N8 0LT	[Signature]
22	Sylebi Abubakar	84	N8 0LJ	[Signature]
21	K. Candrea	79	N6 0LJ	[Signature]
24	G. Willinson	70	N8 0LJ	[Signature]
25	P. MAFFEI-KOTZE	66B	N8 0LJ	[Signature]
26	L. MAFFEI	66B	N8 0LJ	[Signature]
27	J. KOTZE	66B	N8 0LJ	[Signature]
28	J. Wetherden	64	N8 0LJ	[Signature]
29	N. Vonckx	58a	N8 0PP	[Signature]
30	N. Palma	58b	N8 0PP	[Signature]
31	C. Palma	58c	N8 0PP	[Signature]
32	J. HEALY	56A	N8 0PP	[Signature]
33	O. Ohwojaye	56B	N8 0PP	[Signature]
34	P. Ohwojaye	56B	N8 0PP	[Signature]
35	A. Agathangelou	48	N8 0PP	[Signature]
36	L. Agathangelou	50	N8 0PP	[Signature]
37				

Shah Noshaba

From: Debbie Shedden (Boys) [deb.boys@gmail.com]
Sent: 14 April 2013 23:20
To: Licensing
Subject: Objection to proposed off licensed for a Mini-market at 108 Alexandra Road N8

Dear Sirs,

I am a local resident, living at 27 Ravenstone Road and I would like to register my objection to the proposed licence to sell alcohol at a mini market in Alexandra Road. There are several reasons for this:

1. This area was one of the spark points for rioting in August 2011, when Boots at the corner of Alexandra Road was one of a number of shops that got smashed up and looted. It was very frightening. I would be most reluctant to see a shop selling alcohol in a residential road close to Wood Green High Road as had it been there then I am sure that it would have spread the rioting into the residential streets as well, with people wanting to get hold of free booze.
2. The off licence opposite Turnpike Lane is often quite frightening to walk past at night, with drunks hanging around there. A lot is being done to try and improve the image of Wood Green and the residential roads that lie between it and Turnpike Lane. An off licence would make another area also feel unsafe, especially as it is so close to the alley way by Boots which is an essential thoroughfare between Wood Green and Hornsey Park Road.
3. It seems likely that it would increase the noise and nuisance as people come out of films in Wood Green. Both Morrisons and Sainsbury offer alcohol close by until quite late at night and these at least are on the High Street and not a residential road.

It is a very good thing to see new businesses coming into the area, although it is sad to see the pet shop go after so many years. It's just the problem with more alcohol, particularly if this was available later in the evening.

I hope you will register my objections.

Yours sincerely,

Deborah Shedden

This email has been scanned by the Symantec Email Security.cloud service.
For more information please visit <http://www.symanteccloud.com>

Shah Noshaba

From: alison_payne2@blueyonder.co.uk
Sent: 14 April 2013 21:37
To: Licensing
Subject: Licence for mini-mart Alexandra Road

As a resident of Malvern Road I would like to register my objection to the application for a licence to sell alcohol at the location of what was previously Joanna's fish and reptile shop. A retailer selling alcohol would encourage increased public nuisance and risk to safety in a residential area with many children.

Best regards

Alison Payne

44 Malvern Road N8 0LA

Sent from my BlackBerry® wireless device

This email has been scanned by the Symantec Email Security.cloud service.
For more information please visit <http://www.symanteccloud.com>

Shah Noshaba

From: havva ratip [havey02@hotmail.co.uk]
Sent: 14 April 2013 21:13
To: Licensing
Subject: OBJECTION TO JOANNA'S PET AND AQUATICS STORE

I am writing to object to the application for a licence for the sale of alcohol from a new mini-market in the former premises of Joanna's (pet and aquatics) store.

My reason for objection are stated below:

- * The prevention of crime and disorder
- * Public safety
- * The prevention of public nuisance
- * The protection of children from harm

Thank You.

I would appreciate being informed of the outcome of this application, if possible.

havva ratip
9 ravenstone road, hornsey, london n8 0jt

This email has been scanned by the Symantec Email Security.cloud service.
For more information please visit <http://www.symanteccloud.com>



PARKSIDE MALVERN RESIDENTS ASSOCIATION

Alexandra Road, Hornsey Park Road, Malvern Road, Park Ridings, Ravenstone Road
and The Avenue, N8 - www.PMRA.co.uk

(Reply by email to parksidemalvernra@googlemail.com or by post c/o 5 Malvern Road, N8 0LE)

Haringey Council
Licensing Team
Units 271-272 Lee Valley Technopark
Ashely Road
Tottenham
N17 9LN

12th April, 2013

Dear Sir

Re Application for a Premises Licence at 108 Alexandra Road, London, N8 0LJ

We write on behalf of Parkside Malvern Residents Association (PMRA), the registered residents association covering Alexandra Road, in connection with the application for a Premises Licence for the sale of alcohol, seven days a week from 07.00 to 23.00hrs.

The Association was established in 1999, acts by formal constitution and manages the local Sunrise Neighbourhood Watch. The Association is acutely aware of the many problems affecting this corner of our area and has for a number of years been working with Haringey Council councillors, residents, the management of The Mall, social housing landlords and police to address these issues.

The Association wishes to record its objection to this application under the Licensing Act 2003 in keeping with the given criteria: Prevention of Crime and Disorder, Prevention of Public Nuisance, and the Protection of Children from Harm. The off-licence would give rise to substantial public nuisance between the store and the nearby community and should be rejected for a whole variety of reasons, including but not limited to:

- The prevention of crime and disorder
- Public safety
- The prevention of public nuisance
- The protection of children from harm

The application site is in a residential area with a community vulnerable to the effects of antisocial behaviour and crime from the nearby town centre. The immediate area was badly affected by the looting and disturbances in Wood Green, following the Tottenham riots in 2011. The harsh physical environment, lack of ownership and purpose of the space between the site and High Road already encourages anti-social behaviour and crime (urinating in the street, street crime and petty vandalism, begging, rough sleeping, drug dealing and burglary). Many residents feel insecure and live in strong fear of crime. The immediate and extended availability of alcohol will add to this, causing harm to a fragile and vulnerable residential community.

The site is located in the sub-area of the ward with the highest incidence of recorded crime and antisocial behaviour is the highest recorded crime in the ward. The sub-ward area covers streets and alleyways of identical character to the vicinity of the site and therefore whatever happens in the near vicinity can be expected to be repeated around the site.

Cont.../2



PARKSIDE MALVERN RESIDENTS ASSOCIATION

**Alexandra Road, Hornsey Park Road, Malvern Road, Park Ridings, Ravenstone Road
and The Avenue, N8 - www.PMRA.co.uk**

(Reply by email to parksidemalvernra@googlemail.com or by post c/o 5 Malvern Road, N8 0LE)

- 2 -

It is common knowledge that consumption of alcohol, particularly by those who are young and frequently under age, fuels antisocial behaviour. Managing the sale of alcohol at its source will not prevent the problem being dispersed into the immediate neighbourhood, particularly the alleyway and mews. One nearby (Dovecote Mews), on the opposite side of the High Road already suffers heavily from this and its adjacency to an off license in Lymington Avenue.

The area suffers from a significant quantity of low quality rented accommodation, where vulnerable people, often with a history of alcohol addiction and mental health problems make their home. The immediate availability of alcohol is part of a 'revolving door' problem that sustains a cycle of poor health, unemployment, isolation, exclusion, and inability to support oneself - often far from family or home culture.

It is common knowledge that consumption of alcohol, particularly by those who are young and frequently under age, fuels antisocial behaviour. In a recent study published by Alcohol Concern, the amount of alcohol drunk by children varies according to how many off-licences are in the area where they live. With some area children already exhibiting problematic and antisocial behaviour, permitting this license to a shop in the immediate locality would be most unwise. Alcohol Concern's chief executive, Don Shenker, in a Guardian article on 3rd September 2011 said: "The increase in hospital admissions among young drinkers is a cause of real concern and it is particularly worrying that the increased number and concentration of off-licences may be contributing to this. Local areas must have the ability to decide for themselves how many licensed premises they allow..."

We already have stores in relatively close proximity to the area that are licensed to sell alcohol. These are on busy streets in the town centre, subject to CCTV and managed by public services, yet there is still a significant amount of anti-social behaviour and crime. The site for which this application is being made, across from and parallel to alleys that are havens for antisocial behaviour, is remote from CCTV and such services, and therefore the adverse effects of alcohol availability on our community will go unmanaged.

Another store of this nature, this time in our own area, our very neighbourhood, and open for longer hours cannot be acceptable, and would only exacerbate an antisocial crime problem. We strongly urge the Licensing Authority to refuse this application.

Yours faithfully

Marcus Ballard - Chair

Ryan Burton King - Vice Chair and Neighbourhood Watch Co-ordinator

For and on behalf of Parkside Malvern Residents Association and the Sunrise Neighbourhood Watch

App 5– Representation in support from Other Parties

Shah Noshaba

From: askorali21@googlemail.com
Sent: 12 April 2013 15:57
To: Licensing
Subject: Letter of support

Mrs Hasna Ali
161 Hornsey park road
London
N8 0JX

To who may concern,

I am writing this letter to you in regards to 108 Alexandra road N8 0LJ.

This is not a letter to put my concerns forward but to actually support this, I was walking passed this place few days ago and having lived here for a very long time, I was very curious, so I looked through the door and there were builders and also the young gentlemen Mr Onar Bozoglu.

We had a very lengthy conversation and wanted to actually find out exactly what he was doing.

He was a down to earth individual and shared his project with me who I found really interesting, he also told me he will be looking after the neighbourhood and offering security measures such as CCTV externally and internally as well as a well lit store with signs to tackle bad behaviour.

This business will benefit me and family as we live very close by and I suffer from poor health and am a disabled badge holder, we normally travel to Turnpike lane just for a pint of milk or bread so for this to be close to us it is beneficial and I will support this business.

Please forward this onto Mr Onar Bozoglu.

Thank you for taking time to read this and best of luck.

Mrs H Ali

This email has been scanned by the Symantec Email Security.cloud service.
For more information please visit <http://www.symanteccloud.com>

App 6– Response from applicant

Mr Onur Bozoglu
108 Alexandra road
London
N8 0LJ

14/04/2013

Licensing Team
Units 271-272
Lea Valley Technopark
Tottenham
N17 9LN

RE: 108 Alexandra Road, London, N8 0LJ

Licensing Team, Noel Park Safe Neighbourhood and Councillors

Firstly I would like to introduce myself, my name is Onur Bozoglu, I am 27 years old, current store manager for EE Wood Green and I have lived in Haringey/Wood Green for 20 years.

As you may be aware, the premises quoted above has recently become available to the market and I have expressed my desire by filing for all relevant licensing and leases, if successful I would like to turn the premises into a local mini market, which through various types of market research, most notably data collected from Alexandra Road, Hornsey Road and through employees of several outlets on Wood Green High Street is something the area and the locals are in favour off and is needed as the main sources of produce, daily and basic essentials are quite some distance from the streets mentioned above.

I am well aware of the history of the building, its traditions and more importantly some concerns from Local MP's and Councillors regarding the two alley ways by the premises and also current and potential Anti-Social Behaviour and Public Nuisance. I would like to thank you all for your concerns, being a local and working in Wood Green (100 meters from the premises) I know about current Public Nuisance and Anti-Social Behaviour within Wood Green, more notably by betting shops, late night cafes and also snooker clubs. I pledge to work with Haringey Council, Noel Park Safe Neighbourhood and the Local Community to ensure that any type of public disorder, nuisance and anti-social behaviour is tackled and kept at a minimum.

In this paragraph, I would like to talk about the current objections received for 108 Alexandra Road, the Licensing Act 2003 and also how I, along with my staff plan to tackle the following:

- *The prevention of crime and disorder,
- *The prevention of public nuisance
- *Public safety at licensed premises

* Protection of children from harm

Being a store manager at EE I have been trained and participated in various Human Resources, Ethical and Customer Services courses which have given me the necessary skills to liaise with customers, members of the public and how to defuse and affect outcome of potential difficult situations.

I would like to briefly outline why 108 Alexandra Road, if turned into a mini market will not affect in a negative way the four criteria's noted above, and the measures that I as a proprietor will take to ensure that these criteria's are not breached.

To prevent crime within the local area I pledge to install CCTV both inside and outside the premises. The CCTV will be in colour and also with infra-red for night vision purposes. CCTV will be maintained, kept in good working order and regularly checked to ensure it is constantly working 24 hours a day, 7 days a week. As per the concerns of Local Councillors regarding the two alley ways, I will have CCTV clearly covering both alley ways, Boots and the beginning of Alexandra Road which is the turning point of Wood Green High Road.

CCTV will be recording 24 hours per day as stated, in which the police will have full access and all recordings will be stored and referenced too within a least a calendar month as required per licensing agreement. A clear and legible notice outside the premises will be clearly shown to state trading hours and licensing hours. Trading before or after licensing hours will not be permitted.

I intend to make the shop front and inside as well lit as possible, the shop sign will be colourful and bright and I pledge to make the mini market family friendly and hazard free.

To combat criminal activity and prevent anti-social behaviour, I will have clear and conspicuous notices stating warning that any criminal activity and anti-social behaviour and theft will be reported to the police along with CCTV recording

I along with my members of staff will be fully aware and trained on alcohol sales. We will enforce a strict 'Challenge 21' policy. I am very passionate about not selling alcohol illegally and will have posters around the premises, especially by the till and alcohol section with a 'Challenge 21' poster. As an Alcohol Licences holder I, along with my staff will refuse service if no prove of ID is shown. To further track this we will enforce an 'Incident' or 'Refusal' book with dates, times and descriptions of any member of the public seeking to purchase alcohol either by deceit or via failure to prove its age. Myself and my staff will also be fully Health and Safety and first Aid trained, public and customer safety trained and again to reiterate, fully alcohol trained.

My staff and I will not tolerate any harassment, racism and violence, physical or verbal and will refuse service to anyone who may be heavily alcohol consumed or drug consumed. I vow to not sell to any individual in these circumstances and will report them to the police.

To Prevent Public Nuisance, I will adhere to the licensing terms which are not to sell beyond my licensing hours. I will display 'Please leave premises quietly' and 'Respect our neighbours' signs both inside and outside the premises.

I enforce a strict no smoking inside or outside the premises and my own staff will smoke at the rear of the premises.

I will ensure that the premises is kept clean and hygienic at all times, this will ensure that the public view it as a place of business and will minimise any public nuisance and public disorder.

I have been in contact with Haringey Council and also SITA for contract talk regarding refuse collections. I will ensure that no refuse is left unattended, on the high street or in close proximity to any local residents. I will ensure this is a priority to not only combat public nuisance but also potential pest, vandalism and looting.

All deliveries will be carried out as per licensing terms to ensure locals are not disturbed.

My staff and I will ensure we arrive on site and leave the site in a manner which does not disturb the local residences or contributes to public nuisance.

I will enforce for the reputation of my business, benefit of local residents and also per objections received, that I will not allow or tolerate any customers standing or gathering outside of the premises, they will be asked to leave the premises quietly.

To increase public safety at the premises I will ensure a fire and risk assessment is put in place to ensure the premises is safe, all sections will be labelled to avoid queues, large gathering and potential hazards. All food, dairy products and frozen products will be regularly checked to ensure they have not past its sell date and again are not at risk to the public. All chemicals will kept high shelved and out of reach from children, any stainless steel cutlery and knives again away from children and ID strictly required for sales of any knives.

I will also ensure that when cleaning, all relevant signs are displayed as to not put any member of public at risk.

Protecting children from harm is a priority for me and my staff. As stated I will keep all sharp items and chemicals away from the reach of children. No adult entertainment displayed at children's reach. Provide fully working and high tech CCTV that will show the high street, Alexandra Road and both alley ways to ensure that no anti social behaviour is taking effect and also that no children are at harm, consuming alcohol or part taking in drug use. My staff and I will refuse to sell to anyone member of the public under the age of 21 and will not gain a reputation or a name as a Mini Market that sells to under 21's.

As a proprietor I will dedicate my time, effort to ensure myself and my team give the upmost respect to our customers, members of the public and local residents.

I'm very passionate about opening this business and have taken into account all feedback and objections. I would like to state that I have already liaised with The Noel Park Neighbourhood and put through my plans on how to tackle any potential anti-social behaviour. I believe with the premises being occupied, well lit with 4 members of staff daily on site and numerous CCTV showing both alley ways and beyond will help tackle anti social behaviours, public nuisance and crime. I vow to adhere to my licensing terms and operate on a strict over 21's alcohol sale policy.

All objections put through have rightfully so stated crime, anti-social behaviour and crime, yet these entire objections can be tackled with the right measures which I have briefly detailed on this statement.

I would like to state just what my Mini Market would bring to the area.

*Job opportunities for locals

*Family friendly mini market

- *Daily essentials available
- *Local owner, who is passionate about the area
- *Neighbourhood watch
- *Fund raisers and local charity events

I invite you all too please contact me on my mobile showed below or meet in person so we can discuss how we together can improve Alexandra Road, give the local community something back and together tackle and combat crime, anti-social behaviour public nuisance.

I look forward to hearing from you in the near future,

Yours Sincerely,

Mr Onur Bozoglu
07957905888

onic.bozoglu@gmail.com